

# The Colonial Master Gardener

PUBLICATION OF JCC/WMASTER GARDENER ASSOCIATION &  
VIRGINIA COOPERATIVE EXTENSION



## September 2011

### PRESIDENT'S MESSAGE

BY ROGER EVANS



The School Gardens Project is year round. Last October we had two schools. We now have seven schools that we are advising. J.B. Blayton Elementary School is a new school and will be opening its garden this fall. It's been a long year in the making, with design revisions, planning meetings and the final stages of the school getting contracts for fencing, construction of beds, a shelter, water lines, and purchasing a shed kit that will be constructed by school volunteers.

Blayton opened its doors in September 2010 and realized that one element was missing; a teaching garden for the children. They formed a committee and approached the Master Gardeners for help in October 2010. I was fortunate to be one of the Co-chairs of the School Gardens and had planned the Historic Triangle Community Garden in 2009, so I jumped at the chance to be actively involved in this new project. My mission was to design a garden that looked good, would be a teaching tool, and not to worry about cost. How often do you get an assignment like that? Seven Months, four revisions and five minor design changes later, we had the 95% solution.

Blayton Elementary School is an example of what can be done when a team works together to accomplish a task.

The Master Gardener Program in James City County continues to grow every year. We are successful due to your hard work and support throughout James City and New Kent Counties. I personally thank every one of you for your contributions to our success.

There is more work to be done and we need your help. The Fair Coordinator has been filled by Richard Stratton, Gigi Burrows and Eric Bramfitt. The Publicity Project has been filled by Angela Cingale and Toni Webb.

We still need support for the Speaker's Bureau and Mobile Master Gardener. Please consider volunteering or working with another to fill these two positions. As shown with the Fair Coordinator and the Publicity Project, working together, we can get the job done.

### Monthly Meeting

**September 1**, 9 a.m.,  
Williamsburg Regional  
Library;

Guest Speaker:  
Our very own Sue Liddell,  
Tree Steward

## J.B. Blayton Elementary School Garden

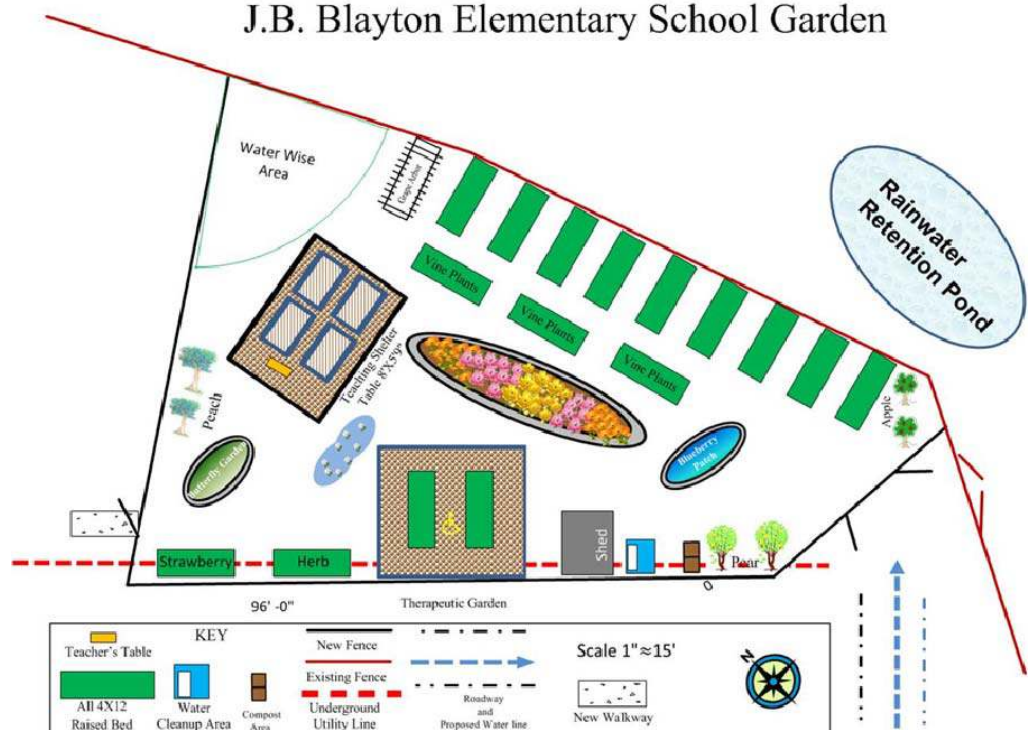

# The Colonial Master Gardener September 2011

2011  
MG Board

*President:*  
Roger Evans

*VP Projects:*  
Beth Fugate

*VP Internal Ed:*  
Harriet Parsons

*VP Administration:*  
Margene Hartsough

*Secretary:*  
Mary Ellen Edwards

*Treasurer:*  
Bob Winther

*VMGA Reps:*  
Marilyn Fiddle and  
Angela Cingale

*Past President:*  
Linda Lucas

*Co-op Ext Rep:*  
Doris Heath  
564-2170

The MG Board meets on the third Friday of each month, at 9:00 am, at the James City County Health and Human Services Building, on Olde Towne Road.

The Board meetings are open to all Master Gardeners, and all are encouraged to attend.

## INTERNAL EDUCATION

BY HARRIET PARSONS

Have you attended any of the various seminars and workshops that I have sent to you via e-mail? Or maybe you have visited an unusual garden center or read about an interesting garden or heard a great speaker. Please let me know if you have, and I will inform the general membership. We are all interested in gardening and who knows, maybe we can plan a trip as a group. For example, I like to check out Amy Stewart's blog, "*Garden Rant*." It is fun and interesting. Did you know that Jim Orband, Senior Extension Agent Emeritus, is on Cathy Lewis's *Hearsay* radio show on NPR 89.5 monthly from 12:00 to 1:00? This month he is scheduled on August 25<sup>th</sup>. I try not to miss it.

I encourage you to attend the 12<sup>th</sup> Annual Fall Gardening Festival presented by the Virginia Beach Master Gardeners on Water-wise gardening at the HRAREC, Saturday, Sept 10, 10-3. There is no better facility qualified to present this important topic. Richmond is not so far to drive so put Sept. 9 on your calendar to attend Lewis Gintner's "*Beautiful Gardens*" workshop and learn about propagating plants. Remember, October 1 is the last day to register for the 2011 International MG Conference scheduled for October 11-14<sup>th</sup> in Charleston, WV.

I was an intern in 2008 and unfortunately our class missed the session on trees. I have always felt a lack of training in this area and so I am looking forward to our September monthly meeting as our presenter will be our own Sue Liddell. Sue is a tree steward and has developed her own Power point presentation to share with us. Bring your questions for Sue. She is our home grown expert. We will also follow up with a field trip led by Dr. Stewart Ware, Biology professor at William & Mary, on September 15<sup>th</sup> at 10:00. Dr. Ware will lead us on a tree identification tour of the campus.



The photo above, taken by Judy Casano, was taken at the *Waterwise Demonstration Garden* located on Old Towne Road at the Human Services Center. The yellow bugs are a type of aphid that commonly attacks Milkweed and Oleander. Our plant is Milkweed. What a shocker it was to discover the plant almost vibrating with the aphids. We have observed the plant the last few months with voracious caterpillars, crystalis formation, monarch butterflies emerging, the milkweed blooming, milkweed pods forming and now covered with aphids! I didn't see the parasitic wasps that attack the aphids but I bet they were there. The pods have now opened to the fluffy seeds we are all familiar with. What a great teaching opportunity. We button-holed several passerby's, including one young man who couldn't believe his eyes, and explained to them what a great host the butterfly friendly milkweed plant is. The *Waterwise Demonstration Garden* can be truly educational. Stop by for a visit sometime.

# The Colonial Master Gardener September 2011

---

## "BEST PLANTS FOR HAMPTON ROADS" BOOK MISSING

SUBMITTED BY CAROL FRYER

WE NEED YOUR HELP..... at the June monthly meeting, someone accidentally took a copy of "*Best Plants for Hampton Roads*" thinking that the booklet was free.

Carol Fryer will need to reimburse the authors \$18 for that copy if she doesn't get it back. Please contact her ASAP at 220-0759 or send her a check for \$18 made out to Laurie J. Fox. No questions asked. Thank you!!

---

## 2012 MG TRAINING CLASS

BY CAROL FRYER

Barb Landa and Carol Fryer are busy getting ready for the 2012 MG training class. Most of our guest speakers have been contacted and are scheduled for the classes. We will be adding a few new topics to our curriculum - House Plants, Roses, Fruit Trees, and Herbs.

Last year we added a session on Weed Identification and Native Plants which will be repeated this year.

Some of the new topics will be added to an existing session. For example, "*Fruits Trees - problems and care*" will be an hour presentation following the 2 hour Vegetable Garden lecture. Laura Viancour will talk about Herbs in addition to Annuals and Bulbs during her session.

Once our class schedule is finalized, we will make it available to the membership via email and/or the MG newsletter.

We are looking forward to an exciting year and if you have friends or neighbors who might be interested in becoming a Master Gardener, please let them know that an application can be obtained from our James City/Williamsburg VCE office, 3127 Forge Rd., Toano, 757-564-2170.

Master Gardeners will be able to audit classes if room is available. Later in the year, we will identify a contact person who will accept your request to attend specific class(es). Happy Fall Gardening!

## VIRGINIA MG EVENTS

BY ANGELA CINGALE

There is still time to take advantage of educational programs from other units. Please visit their website/ VMGAs or e-mail to register at your earliest convenience.

### **CULTIVATING COMMUNITY FOOD SYSTEMS**

SEPTEMBER 24, 2011 - 8 A.M. to 3 P.M.

Rockingham County Admin Center, Harrisonburg, VA. Food shapes our lives, communities and world in many ways. In this special workshop, we will explore how community food systems link all the VCE-MG program objectives together. Learn how you, as a Master Gardener volunteer, can play a vital role in fostering community food systems by "connecting the dots" between the farmer and consumer! Hosted by the Central Shenandoah Valley MG Association (CSVMGA) and VMGA. For more information contact: [vmgaedu@rcn.com](mailto:vmgaedu@rcn.com) OR [csvmqaprograms@gmail.com](mailto:csvmqaprograms@gmail.com)

### **COLOR IT GREEN—"In a Wild and Wonderful Way"**

What an opportunity to be so close to home and be able to enjoy the International MG Conference will be held in Charleston, West Virginia! From October 11th – 14<sup>th</sup>, explore southern West Virginia's charm, heritage and beauty on the "Southern West Virginia" tour. Stops include Tamarack, the Greenbrier and the Pearl S. Buck house. Other options include the "Allegheny Highlands Tour" through scenic West Virginia. Explore the beauty and splendor of the mountain state while traveling through the Monongahela National Forest. For further information, please visit <http://imgc.ext.wvu.edu/>

### **WATERWISE LANDSCAPING: GOOD PRACTICES=GOOD WATER QUALITY**

OCTOBER 22, 2011 - 9 A.M. to 3 P.M.

Using the Riparian Buffer Garden installed by the Franklin County Master Gardeners at the 4-H Center as an example, participants will learn about various ways to use landscaping practices to protect water quality: riparian buffers, rain gardens, safe fertilizers and many other ideas. Hosted by VMGA and Franklin County Master Gardeners. For more information contact: Nelda Purcell (540) 576-9931.

## INVASIVE PLANTS IN VIRGINIA

BY JEANNE MILLIN

Perhaps prompted by my article in last month's newsletter, I received two invasive inquiries this month from Master Gardeners and one request about invasive Japanese Stilt Grass from the staff at New Quarter Park.

*Japanese Stilt Grass* is a persistent concern. A team comprised of Master Naturalists, Friends of New Quarter Park and local Boy Scouts have been working over a period of three years to control and remove *Japanese Stilt Grass*, *Japanese Honeysuckle*, *Purple Loosestrife* and *Beefsteak Plants* from various areas within New Quarter Park. We are winning but it isn't easy and it requires commitment over a period of years. What I have learned, especially concerning the Japanese Stilt Grass is that it must be pulled by hand, late in the growing season, just prior to seed production. If you pull it earlier you just disturb the soil and allow the seeds in the soil to sprout. Estimates are that you need a six to seven year commitment to completely remove the seeds and the grass from the area. Look for our fall request for volunteers for our work days.

The second request was for identification of potential *Phragmites australis* (Common Reed) from a wetland area of a Master Gardeners home. I happened to be volunteering the day after the specimen was dropped off at my home at the New Kent Forestry Center. The leader of our project was a VIMS doctoral candidate who is familiar with wetland plants. I felt better when he explained that many people have trouble identifying *Phragmites*, mixing it up with the Wild Rice that this specimen turned out to be. However, *Phragmites* is becoming a problem in this area and property owners should monitor potential invasions. Repeated mowing and applications of Glyphosate herbicides is the recommended procedure to handle this invasive.

Finally, the invasion of *Pueraria Montana* or Kudzu vine in many places in James City and New Kent Counties and throughout the south. Like many invasive's, Kudzu destroys native trees and shrubs. Kudzu is especially vigorous and difficult to control. In the areas of the country where Kudzu is under control the state DNR and local officials are working together and are committed to the effort, knowing control will take commitments of five to ten years (estimates are one year of attack for each year a stand has been

## LANDSCAPE LOVE

BY ANNE NIELSEN



Landscape Love is already collecting registrations for the Fall session. After another hot summer, I am sure that the requests for help will be numerous. We have several openings for new or returning team members as a few MGs are off on vacation in September and October. Email me at [anne-mail@cox.net](mailto:anne-mail@cox.net) if you are interested. It is very rewarding to help area residents solve their landscape problems.

Some of our online forms have also changed. The **VISIT REPORT FILED BY MASTER GARDENERS** can now be used as the report to homeowners. The report will come to me and I will forward it to the homeowner. This will save some time and expedite the process. If it doesn't help us then we'll work on something new!! Teams are always able to use their own forms as long as the essential information is included.

Registrations close on September 15th. If you have friends or neighbors who need help, urge them to sign up on the website.

allowed to grow). Kudzu is a perennial, leguminous vine. It is deciduous and can grow up to 50 feet in a single growing season. Its roots are deep and starch-rich, storing food reserves that support its regrowth each spring. August and September are prime months for starting a Kudzu attack program since these are the months where the plants start storing food for next year's regrowth. Eradication can take many forms. Repeated mowing weakens the tangle of leaves and vines, grazing and burning are also possible as well as application of a kudzu specific herbicide. Persistent strategies as well as attacking patches when they are small can work. A single crown can start an invasion. Commitment to control in Virginia and in James City and New Kent Counties over a period of years has to become a priority of our government if we are to attack this invasive before it destroys all of the beautiful plants and trees of the area.

# The Colonial Master Gardener September 2011

---

## NEW MG HOURS RECORDING SYSTEM

SUBMITTED BY LINDA LUCAS

Virginia Tech has purchased a new online system from the University of California for recording hours in a consistent fashion throughout the state. The Master Gardener Coordinator, Dave Close, has invited six MG units to try out the new hours recording system, which will be used by all MG units in the state eventually. Officially it is called the Virginia Management System (VMS).

Art Gustafson, John Giffin, Dave Banks and Linda Lucas have been working with this new system and have trained a number of Project Chairs, experienced MG's, and members of the Board. Many of you got an introduction to the system at the August 4<sup>th</sup> MG meeting as well. Our experience so far is that the program is user friendly. If you are not yet registered in the system, we encourage you to follow the directions below and do the registration. Once you get into the system, we invite you to try it out using the **JCC-W Test program. Do not use the James City County/Williamsburg program until we go officially on line January 1, 2012!** This is important. Our target date to start using the James City County/Williamsburg program to actually record our hours is January 1, 2012. Until that date, you can check out the new system, add information to your profile (even a photo of yourself!) and practice entering hours and contact info.

Dave Banks is taking over hours recording from Art Gustafson now. You will **continue recording your hours as usual until the end of this year**...either via online submission or by filling in the hours form and dropping it in the hours basket at the MG meetings or mailing it to Dave Banks ( 215 Charter House Lane, Williamsburg, VA 23188).

We hope all of you will start learning the system now, though. Give it a try before the September 1<sup>st</sup> MG meeting. Here's how to get started. Go to <https://virginia.volunteersystem.org> and click on "New user?". You will get a screen asking for your e-mail. Enter your e-mail and click on "Receive email to access portal". Then minimize your browser and open your e-mail. You should have received an email from 'dclose' at Virginia Tech. This email will give you a temporary password, good for 1 time only. Go back to the volunteer system website and enter your e-mail and the temporary password that you were sent. Then click on **JCC-W Test** to try out the new system. To repeat, our plan is to use the **JCC-W Test** program for practice.

Once you are into the system, the first thing to do is update your profile. You must create, enter, and save a new password and use that one when you re-enter the system. (The one you receive from Dave Close is only good for one time.) The information you enter in your profile is only visible to other JCC/W MGs...just like our roster; so we ask that you not "hide" that info. Don't forget to hit "Save information" after filling in the blanks!

When you get into the system, you will be reminded about three agreements that you have not completed. You can either just ignore them (each time you enter) or go ahead and complete the agreements to make the reminder go away. Since you're in the test system, these aren't valid anyway. However, when we move to the official system January 1, these agreements will appear again for our Virginia system...and responding to them then will eliminate the need for our annual letter and the various volunteer forms we are asked to complete.

Our current projects have been entered as they are listed on our current hours' sheet. (The project labels might change before we go to the official system in January.) We encourage you to "practice" with the system...but **please remember that you must still turn in your hours as usual until the end of this year if you want them to count!**

There will be time for some questions at the September meeting if you have a problem. You can also email John Giffin ([giffinj@cox.net](mailto:giffinj@cox.net)) or Dave Banks ([dfbanks@earthlink.net](mailto:dfbanks@earthlink.net)). Linda Lucas will be available as well before August 28 and after September 8 ([esllal@cox.net](mailto:esllal@cox.net)). We'll all have several months to practice before we begin using the new system. Do get started now, though, so we can iron out any problems before January 1.

## SEPTEMBER WILDFLOWER OF THE MONTH

BY HELEN HAMILTON, JOHN CLAYTON CHAPTER,  
VIRGINIA NATIVE PLANT SOCIETY

### POKEWEED

#### *Phytolacca americana*

Commonly considered a weed, birds love this plant. Growing over three feet tall, and branching almost as wide, the reddish stems carry loose columns of small white or pinkish flowers. In late summer drooping clusters bear glossy purple-black berries.

Preferring moist soil, Pokeweed is found in damp thickets, clearing, and roadsides in every county of the state of Virginia, and in most states. It blooms July-September.

**All parts of this plant are poisonous, specially the roots, seeds and mature stems and leaves.** However, the young tender leaves can be eaten but only as thoroughly cooked greens, with two changes of water. American Indians found many medicinal uses for the plant and many folk remedies make use of parts of the plant. The berry juice was used as a dye by the early colonists and to improve cheap wine.



**Photo:** Pokeweed (*Phytolacca americana*) taken by Helen Hamilton

Songbirds, fox, raccoon and opossum consume the berries, apparently immune to the toxic chemicals. These animals help distribute the seeds far and wide. Pokeweed is deer resistant, because the foliage and stems are somewhat toxic and bitter, particularly when mature.

The plant contains a highly toxic chemical that is being investigated for anticancer and anti-HIV potential. For more information about native plants visit [www.claytonvnps.org](http://www.claytonvnps.org).

---

## BY LAW CHANGE RECOMMENDATIONS

SUBMITTED BY MARGENE HARTSOUGH

The Board approved the following three changes to the ByLaws. Please review these changes and be prepared to vote on them at the **November meeting**.

### Article V Committees and Vacancies

Add another section as follows:

**Section 4. Nominating Committee shall be appointed by the Administrative Vice President with the approval of the Executive Board. The Nominating Committee shall consist of five members covering a spectrum of participants from different class years, project involvement, intern training coordinators, board experience, members of New Kent and previous nominating committee members.**

Rational: to bring bylaws into compliance with current practice and to insure a diverse committee is selected.

### Article VII Meetings

Section 2. delete the sentence reading: The President

shall appoint a nominating committee responsible for nominating a slate of officers.

Rational: To bring the bylaws into compliance with current practice.

### Article VIII Amendments and Procedures

Section 1 delete sentence reading: Proposed amendments shall have been submitted to the membership in writing at the previous meeting.

New Section 1 to read:

**Section 1. These bylaws may be amended at any meeting of the Association by a majority vote of those present. Proposed amendments shall be distributed to the membership through the monthly newsletter and/or electronically no less that 45 days prior to the membership vote.**

Rational: By sending members proposed amendment changes at least 45 days prior to a vote whether receiving electronically or via the newsletter members will have had ample opportunity to consider the change and be ready to cast a vote. There is no need to make paper copies to be passed out at meetings.

## YOU KNOW YOU'RE ADDICTED TO GARDENING WHEN...

-AUTHOR UNKNOWN

Your neighbors recognize you in your pajamas, rubber clogs and a cup of coffee.  
You grab other people's banana peels, coffee grinds, apple cores, etc. for your compost pile.  
You have to wash your hair to get your fingernails clean.  
All your neighbors come and ask you questions.  
You know the temperature of your compost every day.  
You buy a bigger truck so that you can haul more mulch.  
You enjoy crushing Japanese beetles because you like the sound that it makes.  
Your boss makes "taking care of the office plants" an official part of your job description.  
Everything you touch turns to "fertilizer".  
Your non-gardening spouse becomes conversant in botanical names You find yourself feeling leaves, flowers and trunks of trees wherever you go.  
You dumpster-dive for discarded bulbs after commercial landscapers remove them to plant annuals.  
You plan vacation trips around the locations of botanical gardens, arboreta, historic gardens, etc.  
You sneak home a 7 foot Japanese Maple and wonder if your spouse will notice.  
When considering your budget, plants are more important than groceries You always carry a shovel, bottled water and a plastic bag in your trunk as emergency tools.  
You appreciate your Master Gardener badge more than your jewelry You talk "dirt" at baseball practice.  
You spend more time chopping your kitchen greens for the compost pile than for cooking.  
You like the smell of horse manure better than Estee Lauder.  
You rejoice in rain...even after 10 straight days of it.  
You have pride in how bad your hands look.  
You have a decorative compost container on your kitchen counter.  
You can give away plants easily, but compost is another thing.  
Soil test results actually mean something.  
You understand what IPM means and are happy about it You'd rather go to a nursery to shop than a clothes store.  
You know that Sevin is not a number  
You take every single person who enters your house on a "garden tour"  
You look at your child's sandbox and see a raised bed.  
You ask for tools for Christmas, Mother/Father's day, your Birthday and any other occasion you can think of.  
You can't bear to thin seedlings and throw them away.  
You scold total strangers who don't take care of their potted plants.  
You know how many bags of fertilizer/potting soil,/mulch your car will hold.  
You drive around the neighborhood hoping to score extra bags of leaves for your compost pile  
Your preferred reading matter is seed catalogs  
And last but not least:  
You know that the four seasons are:  
Planning the Garden  
Preparing the Garden  
Gardening  
~and~  
Preparing and Planning for the next Garden

## WATERWISE GARDENING

BY JCC/W WATER STEWARDS



**Properly used sprinkler systems** can deliver a large quantity of water in a short time. They have the disadvantage, however, of excessive evaporation, both during watering and from the plant and soil surface. Early morning watering minimizes water loss.

**The least effective method** for watering is with a hand-held nozzle. Watering with a nozzle has all the disadvantages of watering with a sprinkler. In addition, gardeners seldom are patient enough to do a thorough job of watering with a nozzle so they do not apply enough water and do not distribute it evenly over the bed.

**Trickle or drip irrigation systems and ooze hoses** are very efficient, slowly applying water to vegetable and ornamental gardens. Soil moisture can be maintained at a level most suitable to plant uptake. If properly installed and maintained, little water is lost to evaporation or runoff and water use can be reduced by up to 50 percent. For many situations, the expense of installing a good trickle irrigation system will be compensated by reduced water usage, less replacement of plant materials, and less work. These devices conserve water, prevent soil erosion, and target the water application. Overwatering wastes water, may weaken roots and lead to root decay, and encourages undesirable weed growth.

## TURF LOVE THANK YOU

SUBMITTED BY BOB AND JEAN WINTERS

We would just like to say "thank you" to all of the MGs who attended the Super Turf Saturday program...those who assisted in any way and those who came to learn a bit more about how to tend their lawns and to help the environment at the same time. It was a successful day and we appreciated the support of our fellow MGs!

Bob and Jean Winters

## GUSTAFSONS' ABSENCE

Barbara and Art Gustafson left Williamsburg Tuesday, August 23, to go to Danbury, CT to help Barbara's son recover from serious injuries sustained in a car accident. He will be in a wheelchair for at least three months and then need additional therapy before he will be able to live again independently. They will be moving into a handicap-accessible apartment in Danbury to help him slowly recover. They will be living there and unable to return to Williamsburg until, at the earliest, the beginning of next year.

Linda Lucas, of course, will continue to manage Therapeutic Gardening. Nancy Carnegie and Yvonne Forbes will oversee the Green Team Garden and Linda Lucas will oversee CDR for Incredible Edibles. Dave Banks will take over Volunteer Hours. Art will send a separate notice concerning Composting.

They have a new e-mail, [ajgbsg@gmail.com](mailto:ajgbsg@gmail.com) for anyone who would like to reach them. You may also contact them via Art's cell phone number which is listed on the MG roster. Their temporary new address is Crown Point-Unit 14322, 50 Saw Mill Road, Danbury, CT 06810.

## TREE IDENTIFICATION APP

SUBMITTED BY PATSY MCGRADY

The Smithsonian has put out a Tree Identification App for the iPad2 and iPhone called **Leafsnap**. You take a photo of a given tree leaf (with your iPhone or iPad 2) and the app comes back with a selection of possible tree types. For each possible tree type there are photos of the leaf front and back, leaves on a small branch, flower, fruit, petiole, and bark – so its usually easy to determine which is your actual leaf/tree.

The app also provides a browse capability where it has info on a large number of trees that you browse alphabetically or you can search by giving a specific tree name or a partial name such as "Maple". For each tree the app also gives a description of where the tree is located in the US, it's Habitat, Growth Habit, Bloom Time, Longevity, and the States in which the tree is found. It has been mentioned in the Washington Post. Just connect to the Apple App store, search for the app by name and download. Very easy to use and the price is right. Another little bit of technology magic.



# The Colonial Master Gardener September 2011

## FARMERS' MARKET SCHEDULE

BY SALLY SISSEL

### September 10

*Incredible Edibles  
Sunflower Contest judging*

### September 17

*Trees/Shrubs*

### October 1

*Pruning*

### October 15

*Composting*

### October 29

*Turf plus general Q&A*

## SEPTEMBER 'TO DO' LIST SUBMITTED BY AILENE BARTLETT

Things to do in Zone 7, in September, from Rodale Press's GARDENER TO GARDENER ALMANAC & PEST-CONTROL PRIMER:

(1) early this month, sow seeds of mixed greens for fall and winter salads; (2) harvest young lettuce planted in August; (3) snip off long stems of parsley and freeze in a bag or jar for winter use; (4) trim evergreen hedges, such as holly or viburnum, on the first cool day; (5) set out pansies in spots that will receive full sun all winter; (6) harvest peanuts as soon as the shells become hard.

## NEXT NEWSLETTER DEADLINE:

The deadline for submission of material for the **October Newsletter** is **Monday, September 19.**

Please send to Cathy Lohwater, newsletter editor, at [cathy.lohwater@cox.net](mailto:cathy.lohwater@cox.net) or call 757-259-1133.

## Upcoming Dates to Remember

- 9/1 Monthly Meeting, 9 AM @ WRL
- 9/19 Oct. Newsletter Deadline
- 10/11-15 International MG Conference, WV

## CAR WASHING

BY JCC/W WATER STEWARDS



Home car washing can be a major contributor to phosphorus pollution as a result of soapy water running into storm drains, carrying with it soap, oil, sludge and road film.

Wash your car on your grass instead of in your driveway, and use non-phosphate soaps. Or take it to a commercial car wash that treats its wastewater.

Also, be careful when changing your oil or other fluids, clean up spills right away, and take used motor oil to a recycling center.

### JCC/W Master Gardener Mission Statement

*The purpose of the James City County/ Williamsburg Master Gardener is to learn, educate, and communicate environmentally sound horticultural practices to the community.*

*Trained by the Virginia Cooperative Extension, Master Gardener volunteers are committed to offering information to the public through sustainable landscape management educational programs.*

## SUNSHINE NOTES

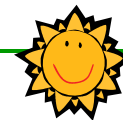

If you know a Master Gardener who is ill, facing surgery, has suffered a family loss, or any event in which that person might benefit from a **sunshine note**, please contact the MG Secretary, Mary Ellen Edwards. She will send a note or take appropriate action on behalf of the organization. Mary Ellen may be reached at (804) 966-9366 or [JMEMEE12350@verizon.net](mailto:JMEMEE12350@verizon.net).

## ABOUT THE VIRGINIA MASTER GARDENERS AND VIRGINIA COOPERATIVE EXTENSION

Virginia Master Gardeners are volunteer educators who work within their communities to encourage and promote environmentally sound horticulture practices through sustainable landscape management education and training. As an educational program of Virginia Cooperative Extension, Virginia Master Gardeners bring the resources of Virginia's land-grant universities, Virginia Tech and Virginia State University, to the people of the commonwealth.

Extension is a joint program of Virginia Tech, Virginia State University, the U.S. Department of Agriculture, and state and local governments. Virginia Cooperative Extension programs and employment are open to all, regardless of race, color, national origin, sex, religion, age, disability, political beliefs, sexual orientation, or marital or family status. An equal opportunity/affirmative action employer.